

E8 户型

2 房 + 书房 + 2 卫

总面积	
930-1,095 平方英尺	
室内	户外
870 平方英尺	60-225 平方英尺



第五层

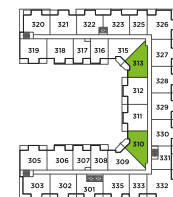

第三层



第二层



地面层

平面图说明

1. 30" 嵌入式冰箱
2. 30" 5头燃气炉灶
3. 30" 对流式入墙烤箱
4. 30" 微波炉抽油烟机
5. 24" 嵌入式洗碗机
6. 全尺寸洗衣机及烘干机

The developer reserves the right to make minor modifications to suite and furniture layout, specifications and floor plans should they be necessary to maintain the high standards of this community. Square footage are based on preliminary measurements and are approximate. E & O.E.

